

Lord

Pierangelo Gallotti
2004



Table with 15mm transparent or extralight glass top. Painted glass as per samples in the bright or satin version, on request. Structure in bright stainless steel (40x20x2mm). Also available in satin stainless steel or embossed white or black lacquered steel. For the XL versions, from 260x110 cm, the top is always in 19mm transparent glass and bright or satin stainless steel structure (50x25x3mm).

Cm (L x P x H)

140 x 140 x 74
164 x 90 x 74
186 x 90 x 74
200 x 100 x 74
220 x 100 x 74
240 x 100 x 74
260 x 110 x 74
280 x 110 x 74
300 x 110 x 74
320 x 110 x 74
340 x 110 x 74
360 x 110 x 74
380 x 110 x 74

Inches (L x P x H)

55³/₄ x 55³/₄ x 29³/₄
64³/₄ x 35¹/₂ x 29³/₄
73³/₄ x 35¹/₂ x 29³/₄
78³/₄ x 39¹/₂ x 29³/₄
86³/₄ x 39¹/₂ x 29³/₄
94¹/₂ x 39¹/₂ x 29³/₄
102¹/₂ x 43¹/₂ x 29³/₄
110³/₄ x 43¹/₂ x 29³/₄
118³/₄ x 43¹/₂ x 29³/₄
126 x 43¹/₂ x 29³/₄
134 x 43¹/₂ x 29³/₄
141³/₄ x 43¹/₂ x 29³/₄
149³/₄ x 43¹/₂ x 29³/₄

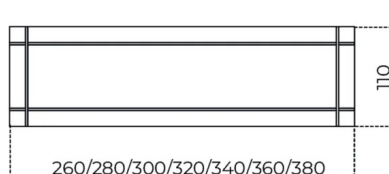
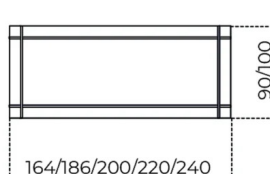
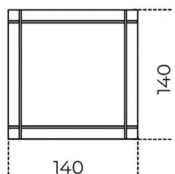

Lord

Lord XL

Finishes

Glass



Bright white



Satin white



Bright blue-grey



Satin blue-grey



Bright cadet blue



Satin cadet blue



Bright cement



Satin cement

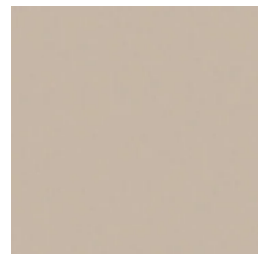

Bright champagne



Satin champagne



Bright rose powder



Satin rose powder



Extralight

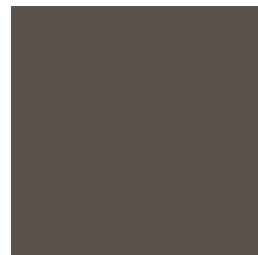

Bright taupe

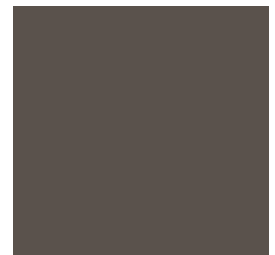

Satin taupe



Bright dark grey



Satin dark grey



Bright liquorice



Satin liquorice

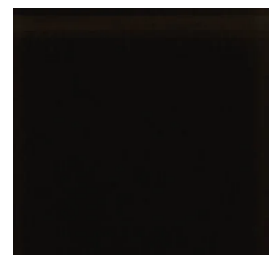

Bright black

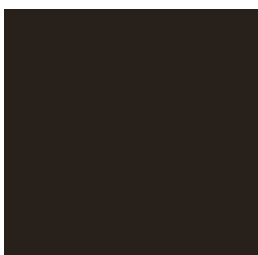

Satin black



Bright olive



Satin olive



Transparent

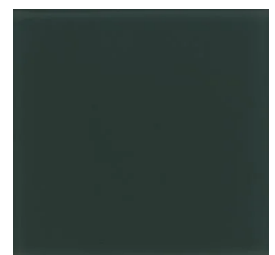

Bright green-grey



Satin green-grey

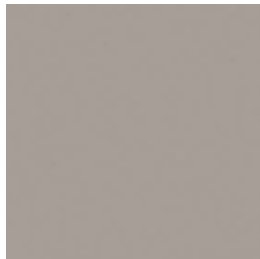

Bright mink



Satin mink

Metal



Bright stainless steel

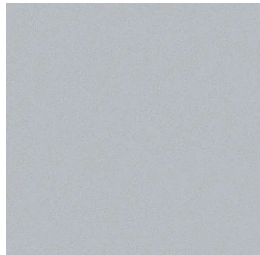

Satin stainless steel



Embossed white

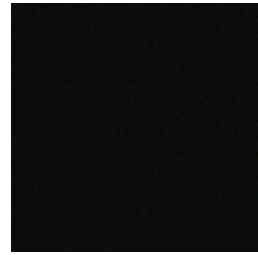

Embossed black